



PUTTERILLS

est. 1992

£1,500 PCM
Hay Wains

Woolmer Green, SG3 6HW

PROPERTY SUMMARY

This modern & attractive two bedroom semi-detached house is situated in a private mews development with views to the rear aspect across open countryside and just a stones throw from the village duck pond, together with access to local transport links and the highly regarded C of E primary school.

The accommodation comprises: Covered porch, entrance hall, cloakroom, lounge with french doors opening to garden, kitchen with a good range of wall and base units. To the first floor is a central landing, 2 bedrooms , and a shower room. Outside is a fenced rear garden with landscaped patio and tool shed, side gated access and views across the countryside.

2



1



1





PUTTERILLS
LETTINGS

est. 1992





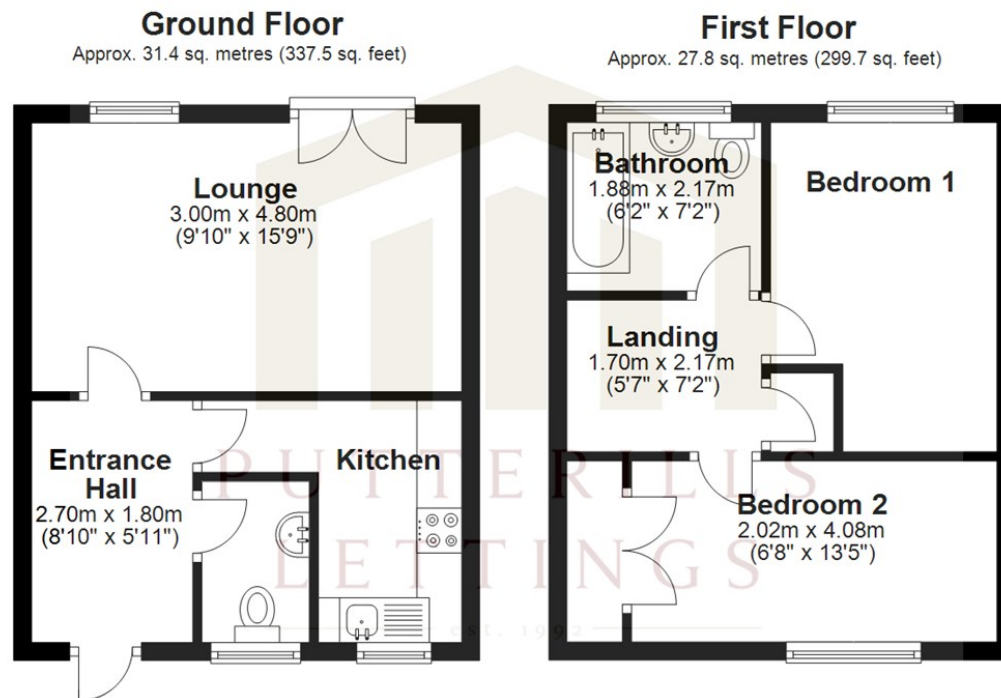

Total area: approx. 59.2 sq. metres (637.1 sq. feet)

Approximate measurements not to scale for room identification purposes only
Plan produced using PlanUp.

LOCAL AUTHORITY
NHDC

TENURE

COUNCIL TAX BAND
D

VIEWINGS
By prior appointment only

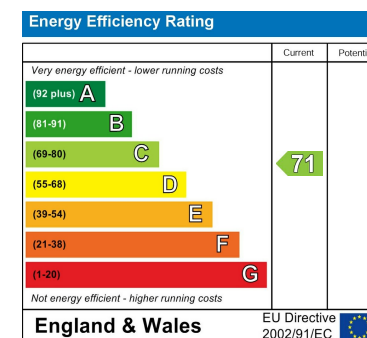

Agents Note: Whilst every care has been taken to prepare these particulars, they are for guidance purposes only. All measurements are approximate and are for general guidance purposes only and whilst every care has been taken to ensure their accuracy, they should not be relied upon and potential buyers/tenants are advised to recheck the measurements



OFFICE ADDRESS

Hill House 1 St Albans Road
Codicote
SG4 8UT

OFFICE DETAILS

01462 419333
lettings@putterills.co.uk
www.putterills.co.uk